

FPO

KITCHENAID®
UNDERCOUNTER
REFRIGERATION



FOR THE WAY IT'S MADE.®

ENTERTAIN NEW IDEAS.

FPO

Shown: KBCA06XPBS Undercounter Refrigerator and KUJA15NRHS Automatic Ice Maker

TURN YOUR CRAVINGS INTO AN ELEGANT COLLECTION.

Your home offers guests a glimpse of your personality and attention to detail. So, for moments when entertaining extends from the kitchen into a great room or home office, KitchenAid® undercounter refrigeration products turn your imagination into reality. Inheriting the design of the Architect® Series, the undercounter collection is part of a larger appliance family and adds refreshing appeal throughout your home. You can stock your exercise room with a supply of bottled water or keep chilled hors d'oeuvres in the foyer. Wherever you place these products, you'll appreciate the elegant styling that complements any room. Wherever you need them, you'll appreciate the modular versatility that allows these appliances to be freestanding or built-in solutions for any room.

The undercounter collection includes a refrigerator, a wine cellar, and 15- and 18-inch automatic ice makers. Used together or as individual design solutions, these products will enhance every occasion.



FOR THE WAY IT'S MADE.®



FPO

UNDERCOUNTER REFRIGERATOR



TAKE A CLOSER LOOK AT REFRESHING POSSIBILITIES.

The compact, undercounter refrigerator lets you bring accessible refreshments into the areas where you entertain. Five cubic feet of storage is flexibly divided for easy access. Our exclusive Superba® Z Shelf lets you neatly stack delicate items, or stock a generous supply of beverage cans. The adjustable ClearVue™ Slide N Lock™ bin and can rack create accessible door storage for bottles, small jars, and cans. As part of the Architect® Series, this refrigerator complements a full line of KitchenAid® major appliances. The undercounter refrigerator can

be used as a freestanding unit or can be recessed into existing cabinets. Combined with a choice of colors, you can give your kitchen an integrated look. An optional trimless trim kit allows you to install a ¾-inch custom panel for a full overlay design.

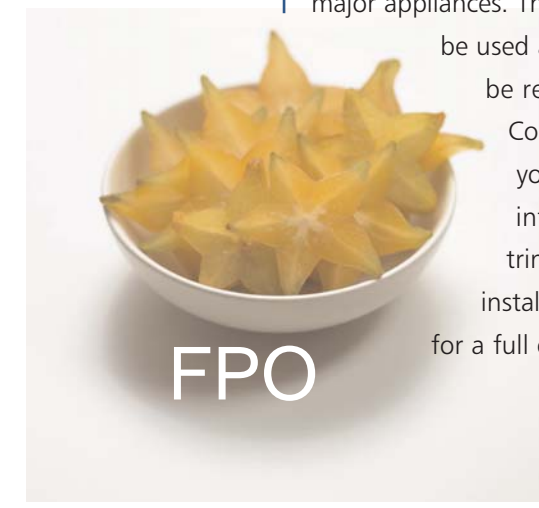

FPO



WINE CELLAR

TAKE THE EXPECTED TO A NEW LEVEL.

A KitchenAid® wine cellar will be appreciated by anyone who delights in the flavorful bouquet of a fine wine. Canted racks let you place up to 48 bottles end-to-end – the proper position for keeping corks moist. A UV-protected, tempered-glass door protects wine from light, a magnetic door gasket helps lock in humidity, and the Tri-Zone™ cooling system allows you to keep white, blush, and red wines of all vintages within their proper temperature range. Your styling choices include stainless, black, and white. For freestanding applications, a stainless door with a stainless-wrap exterior is available. An optional trim kit allows you to install a ¾-inch custom panel for a full overlay design that complements existing cabinets. The appealing design also includes SatinGlide™ slide-out racks that feature stainable wooden front panels.





AUTOMATIC ICE MAKERS



GIVE YOURSELF A CLEAR REASON TO ENTERTAIN.

An ice maker is an elegant addition to any home – and an essential ingredient whenever you entertain. KitchenAid® automatic ice makers can generate up to 50 pounds of ice in a 24-hour period. During the ice making process much of the mineral content is rejected, leaving ice that's clear – not cloudy. The 18-inch automatic ice maker can hold a generous 35 pounds of ice and is easy to access with a drop-down door. The 15-inch automatic ice maker, ideal for narrow spaces, has an attractive side-swing door with the option of a reversible door swing and holds 25 pounds of ice. Select models offer an optional trim kit for custom panel installations.





KITCHENAID HERITAGE

OFFERING A FULL MENU OF INGREDIENTS
TO STIR YOUR CULINARY PASSION.

Throughout its long history, KitchenAid has remained true to its roots as the brand for those who love to cook. Every product and innovation that carries the KitchenAid name is designed with a single goal: to be an essential ingredient in every cook's kitchen.

With each new introduction, KitchenAid continues to deliver the combination of form and function that causes chefs to choose KitchenAid for their homes more than any other brand. Our most recent additions include the boldly styled KitchenAid® Pro Line™ Series, the first coordinated collection of countertop and major appliances. There's also briva®, the first in-sink dishwasher. By combining the functions of a sink and dishwasher, the briva® in-sink dishwasher provides an entirely new tool for cooking and entertaining. And for seasonal or year-round entertaining, you'll appreciate the stylish appeal of the KitchenAid® outdoor kitchen that gives you another opportunity to bring your passion for entertaining to life.



KITCHENAID

PREMIUM FEATURES

LET OUR COLLECTION COMPLEMENT YOUR COLLECTION.

Kitchens, butler's pantries, and home theaters of all varieties can benefit from our collection of undercounter refrigeration products. As part of the KitchenAid® Architect® Series appliance family, these products have a coordinated style that works in whatever direction your entertaining takes you.

The temperature-controlled convenience of a wine cellar is ideal for either casual collectors or connoisseurs. As an integrated part of every room, a KitchenAid® wine cellar offers many features that let you enjoy your passionate pursuit of great wine. **Five canted racks** allow proper storage of up to **48 wine bottles** and includes a **display rack** for your personal favorites or vintage finds. With an undercounter refrigerator, you can keep more than your favorite refreshments conveniently close. A **garnish basket** allows you dedicated space for small bottles, fresh vegetables,

and snacks. The **ClearVue™ Slide N Lock™** door bin gives you all the flexibility of our full-size refrigerators



with convenient storage of 2-liter bottles and 12-ounce cans. And our exclusive **Superba® Z Shelf** gives you

a unique option for many frequently accessed items. Automatic ice makers generate up to **50 pounds of ice** in a **24-hour period** whether you choose a 15- or 18-inch width model.



White, black, and stainless color options reflect popular tastes in interior design. For custom applications, the options are even more enticing. A trim kit allows you to install a **¾-inch panel**. On wine cellars and undercounter refrigerators, the kit disguises the exterior trim for a **full overlay look**. For further customizing, wine cellars have **SatinGlide™** slide-out wine racks with wooden front panels that can be stained to match or complement surrounding cabinets.



UNDERCOUNTER REFRIGERATOR

Superba® Architect® Series
KBCA06XP (6 Cu. Ft.)

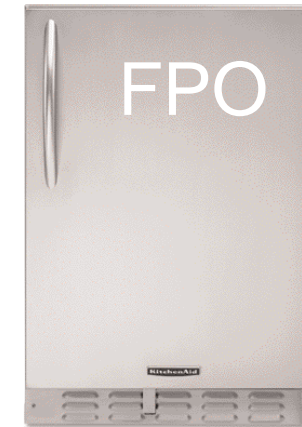

CONVENIENCE

- SpillClean™ Glass Shelf
- Adjustable Superba® Z Shelf
- Garnish Basket
- ClearVue™ Slide N Lock™ Door Bin and Can Rack
- Interior Light

TEMPERATURE MANAGEMENT

- Variable Temperature Control on Base Grill

EFFICIENCY

- Automatic Defrost
- ENERGY STAR® Qualified

STYLING

- Architect® Series Handle

COLORS

- White (WH)
- Black (BL)
- Wrap-Around Stainless Steel Doors with Black Cabinet (BS)

OPTIONAL ACCESSORY

- Trim Kit for Custom Panel Installation

WINE CELLAR

Superba® Architect® Series
KUWA244P



CONVENIENCE

- 48-Bottle Capacity
- Five Canted Wine Racks and a Display Rack
- Interior Light
- ClearVue™ UV-Protected Thermal-Glass Door

PERFORMANCE

- Tri-Zone™ Cooling System

EFFICIENCY

- Automatic Defrost
- Magnetic Door Gasket

EASY TO INSTALL

- Adjustable Leveling Legs

STYLING

- Architect® Series Handle

COLORS

- White Door and Cabinet (WH)
- Black Door and Cabinet (BL)
- Stainless Steel Door with Black Cabinet (BS)
- Stainless Steel Door with Stainless-Wrap Cabinet (SS)

OPTIONAL ACCESSORY

- Trim Kit for Custom Panel Installation



Accessories Copy

AUTOMATIC ICE MAKERS

Architect® Series
KUIA18NNJ (18")



- CONVENIENCE**
- Ice Scoop
 - Lighted Bin
 - Hidden Controls
 - 35-Lb Storage Capacity
 - Drop-Down Door
- PERFORMANCE**
- Up to 50-Lb Production Rate per 24 Hours
- EASY TO INSTALL**
- Adjustable Leveling Legs
- STYLING**
- Architect® Series Handle
- COLOR**
- Stainless Steel (S)
- OPTIONAL ACCESSORIES**
- Drain Pump – Part No. 1901
 - Cleaning Kit – Part No. 0000

KUIA18PNL (18")
Identical to model KUIA18NNJ with a built-in drain pump.

Architect® Series
KUIA15NRH (15")



- CONVENIENCE**
- Ice Scoop
 - Lighted Bin
 - Hidden Controls
 - 25-Lb Storage Capacity
 - Nonreversible Right-Hand Side-Swing Door (Door Hinges on Right)
- PERFORMANCE**
- Up to 50-Lb Production Rate per 24 Hours
- EASY TO INSTALL**
- Adjustable Leveling Legs
 - Zero-Clearance Door Swing
- STYLING**
- Architect® Series Handle
- COLOR**
- Stainless Steel (S)
- OPTIONAL ACCESSORIES**
- Drain Pump – Part No. 1901
 - Cleaning Kit – Part No. 0000

KUIA15NLHS (15")
Identical to model KUIA15NRHS with a nonreversible left-hand side-swing door (door hinges on left).

KUIA15PRL (15")
KUIA15PLL (15")
Identical to models KUIA15NRHS and KUIA15NLH with a built-in drain pump.

Classic Series
KUIS18NNJ (18")



- CONVENIENCE**
- Ice Scoop
 - Lighted Bin
 - Hidden Controls
 - 35-Lb Storage Capacity
 - Drop-Down Door
- PERFORMANCE**
- Up to 50-Lb Production Rate per 24 Hours
- EASY TO INSTALL**
- Adjustable Leveling Legs
- STYLING**
- Integrated Handle
- COLORS**
- White (W)
 - Biscuit (T)
 - Black (B)
 - Black-on-Stainless (S)
- OPTIONAL ACCESSORIES**
- Trim Kit for Custom Panel Installation
 - Drain Pump – Part No. 1901
 - Cleaning Kit – Part No. 0000

KUIS18PNJ (18")
Identical to model KUIS18NNJ with a built-in drain pump. Available in white (W) and black (B).

Classic Series
KUIS15NRH (15")



- CONVENIENCE**
- Ice Scoop
 - Lighted Bin
 - Hidden Controls
 - 25-Lb Storage Capacity
 - Reversible, Side-Swing Door
- PERFORMANCE**
- Up to 50-Lb Production Rate per 24 Hours
- EASY TO INSTALL**
- Adjustable Leveling Legs
 - Zero-Clearance Door Swing
- STYLING**
- Integrated Handle
- COLORS**
- White (W)
 - Biscuit (T)
 - Black (B)
 - Black-on-Stainless (S)
- OPTIONAL ACCESSORIES**
- Trim Kit for Custom Panel Installation
 - Drain Pump – Part No. 1901
 - Cleaning Kit – Part No. 0000

KUIS15PRH (15")
Identical to model KUIS15NRH with a built-in drain pump. Available in white (W) and black (B).

UNDERCOUNTER REFRIGERATOR DIMENSIONS

PRODUCT DIMENSIONS

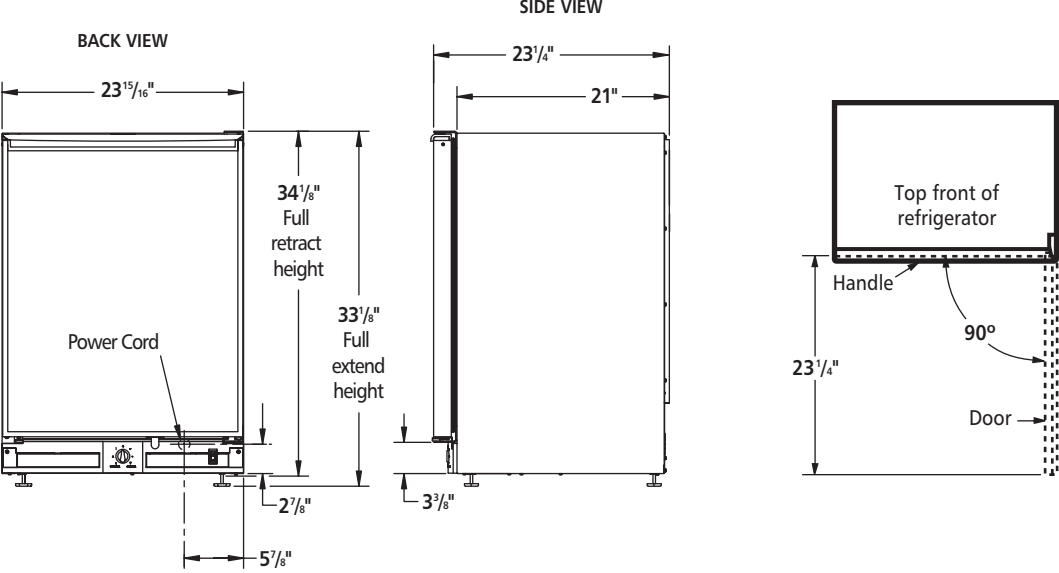

CUTOUT DIMENSIONS

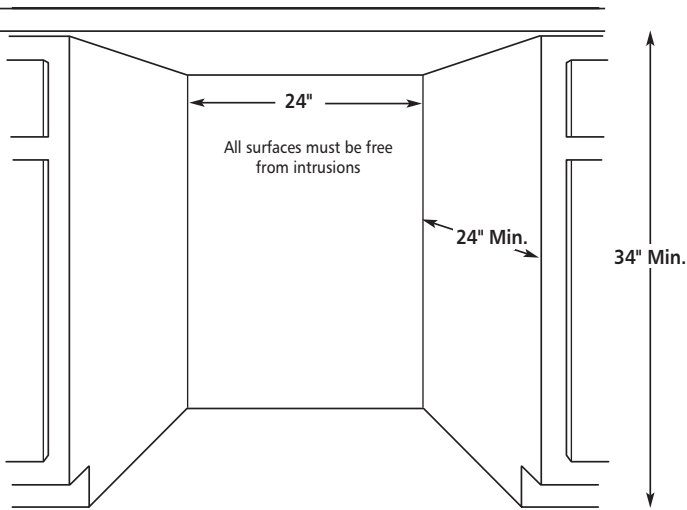

CUSTOM PANEL DIMENSIONS

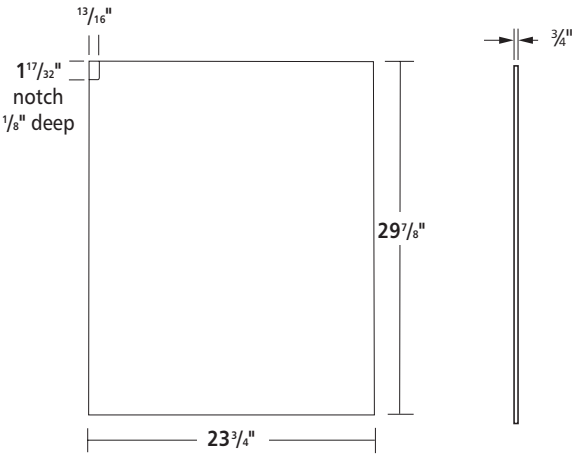

REFRIGERATOR ACCESSORIES

	PART NO.
OVERLAY KIT	
Black	4396785
White	4396786
ACCESSORY	
Can Rack	4396788

WINE CELLAR DIMENSIONS

PRODUCT DIMENSIONS

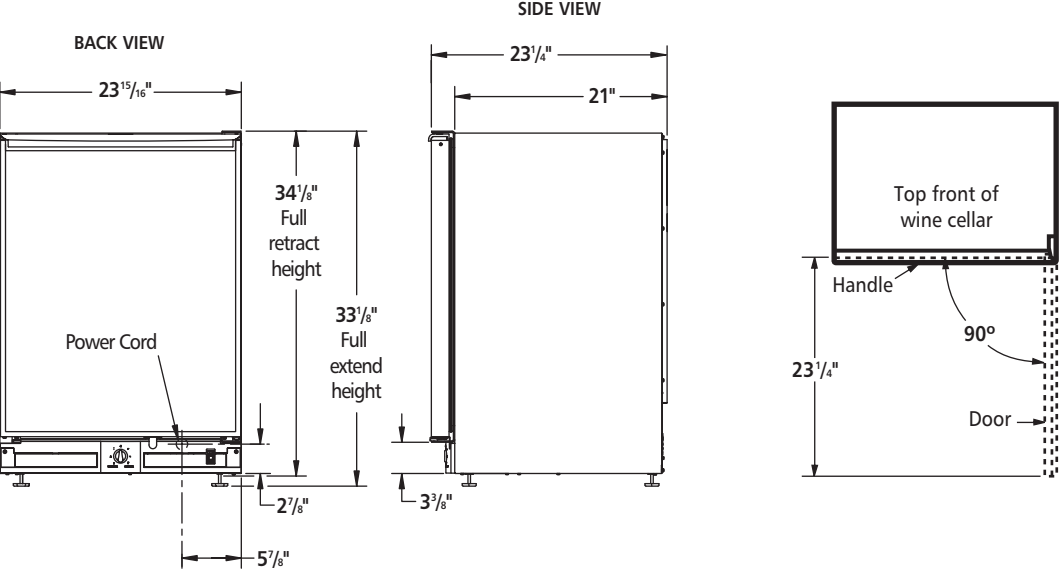

CUTOUT DIMENSIONS

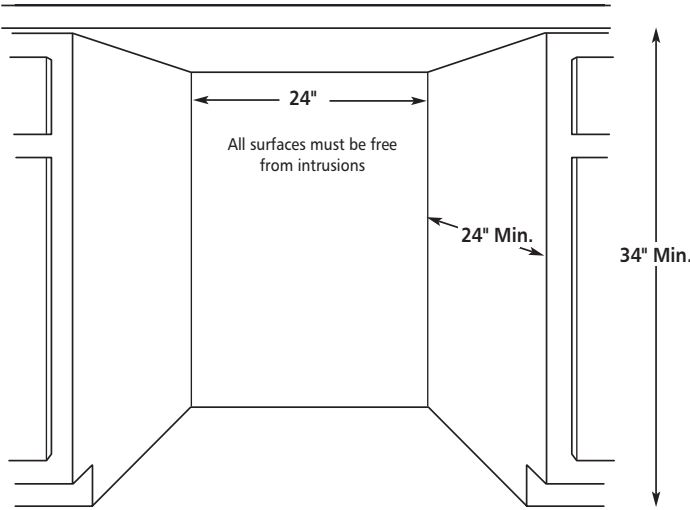

CUSTOM PANEL DIMENSIONS

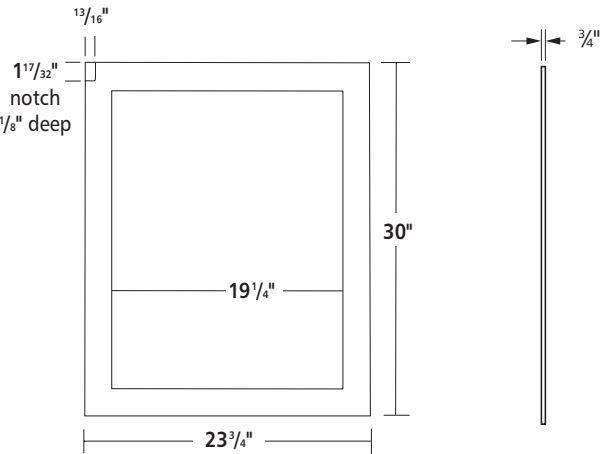

CROSS SECTION

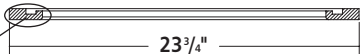

DETAIL

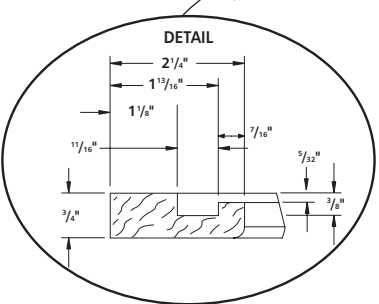

WINE CELLAR ACCESSORY

	PART NO.
OVERLAY KIT	
Black	4396787

Dimensions are for planning purposes only. For complete details, see Installation Instructions packed with product. Specifications subject to change without notice.

ICE MAKER DIMENSIONS

PRODUCT DIMENSIONS – 18-INCH ICE MAKERS

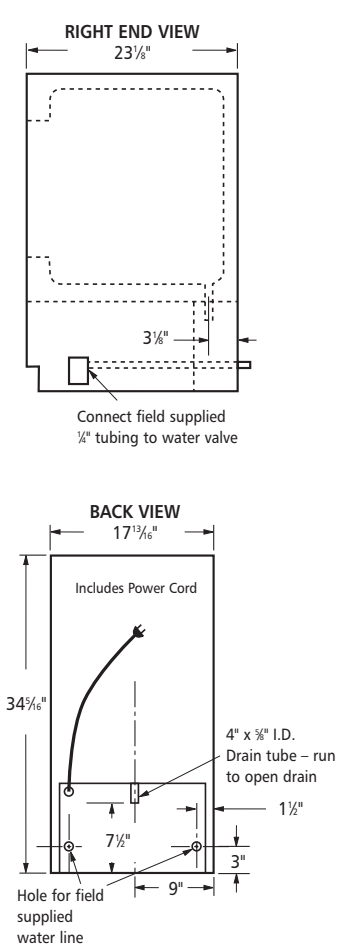

CUTOUT DIMENSIONS – 18-INCH ICE MAKERS

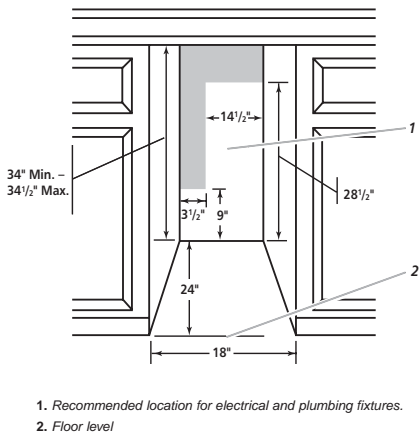

PRODUCT DIMENSIONS – 15-INCH ICE MAKERS

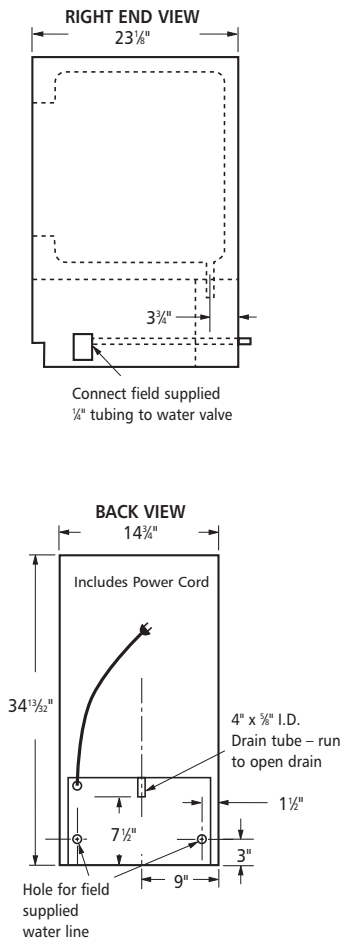

CUTOUT DIMENSIONS – 15-INCH ICE MAKERS

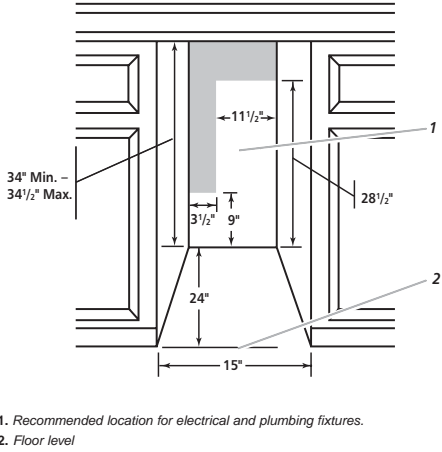

CUSTOM PANEL DIMENSIONS

18-INCH ICE MAKERS – 3/4" THICK PANEL

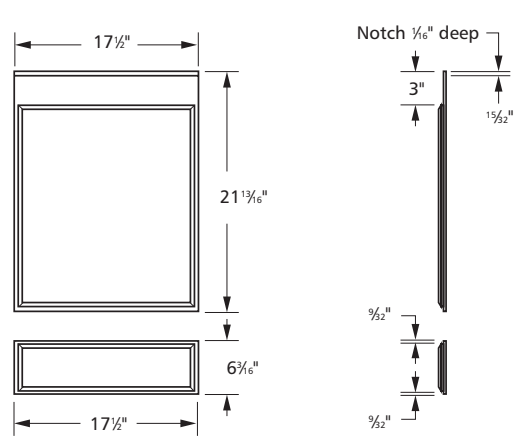

18-INCH ICE MAKERS – 1/4" THICK PANEL

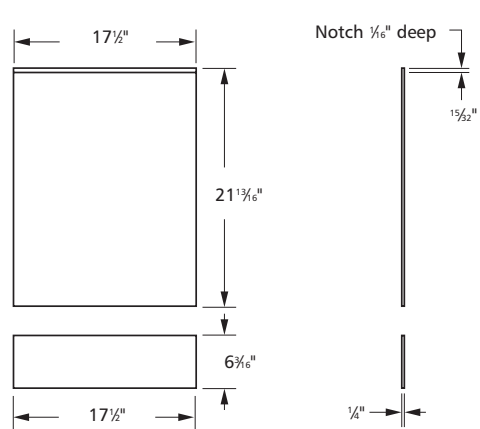

15-INCH ICE MAKERS – 3/4" THICK PANEL

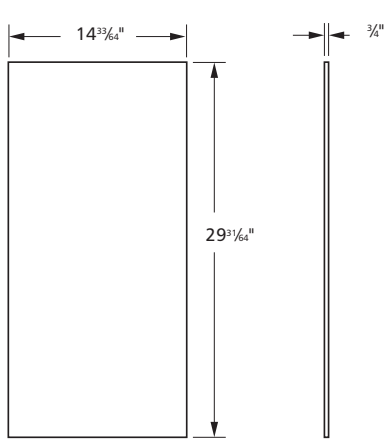

ICE MAKER ACCESSORIES

	MODEL NO.	PART NO.
ACCESSORY TRIM KITS		
18-Inch Ice Makers		
Black	KUIS18NNJB	2929911B
	KUIS18PNJB	
White	KUIS18NNJW	2929911W
	KUIS18PNJW	
Black-on-Stainless	KUIS18NNJS	2929911S
15-Inch Ice Makers		
Black	KUIS15NRHB	8171345
	KUIS15PRHB	
White	KUIS15NRHW	8171343
	KUIS15PRHW	
Black-on-Stainless	KUIS15NRHS	8171347
FILLER KIT ACCESSORY		
Black	KUIS15NRHB	8171485
	KUIS15PRHB	
White	KUIS15NRHW	8171484
	KUIS15PRHW	
Black-on-Stainless	KUIS15NRHS	8171487
Stainless	KUIA15NRHS	8171487
ACCESSORY		
Cleaning Kit		

KITCHENAID® WARRANTY INFORMATION

	FULL (PARTS AND LABOR)	FULL (PARTS AND LABOR)
	1ST YEAR	2ND-5TH YEAR
UNDERCOUNTER REFRIGERATORS	Entire product	Sealed refrigeration system*
50# AUTOMATIC ICE MAKERS	Entire product	Sealed refrigeration system*
WINE CELLARS	Entire product	Sealed refrigeration system*

*Sealed refrigeration system includes compressor, evaporator, condenser, dryer/strainer, and connecting tubing.

CONSUMER INTERACTION CENTER

The experience of owning a KitchenAid® appliance goes beyond styling, a warranty, and even performance. Because at its root, the KitchenAid brand experience is about your aspirations. Our Consumer Interaction Center offers personal support relating to your product questions. We'll help you select the ideal

model, answer questions about appliance operation and performance, and give you a point of contact should you ever need service. Call 1-800-422-1230 to start enjoying the premium experience of owning a KitchenAid® appliance.

KitchenAid has a policy of continuous improvement of products and reserves the right to make improvements or changes without notice.

KitchenAid®
FOR THE WAY IT'S MADE.®
For additional information, visit our Web site at **KitchenAid.com**.

®Registered trademark/™Trademark of KitchenAid, U.S.A.
©2004. All rights reserved.
KitchenAid • Benton Harbor, Michigan 49022 U.S.A.

